

ASSEMBLY INSTRUCTIONS

TAO COFFEE TABLE

01682-x

Tribù nv
Oude Heidestraat 72
3740 Bilzen
BELGIUM

www.tribu.com
info@tribu.com

TRIBÙ
The art of leisure

CONTENT

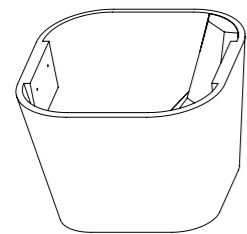

1 x
Base

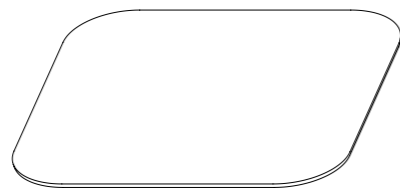

1 x
Top

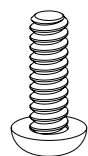

8 x
Screw



8 x
Washer

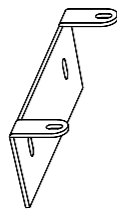

2 x
Mounting
plate



8 x
Glider

ASSEMBLY INSTRUCTIONS

- 1** Use the screws and the washers to secure the mounting plate to the base. Make sure the top of the mounting plate is level to the top of the base.

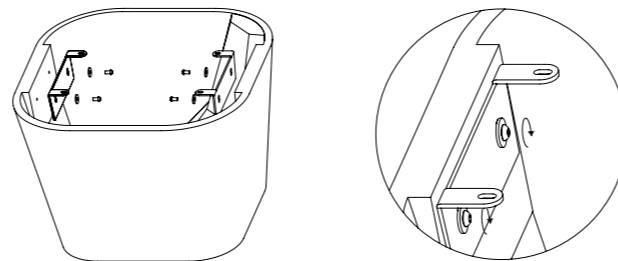

- 2** Unpack the top and place it upside down on a protective cover.

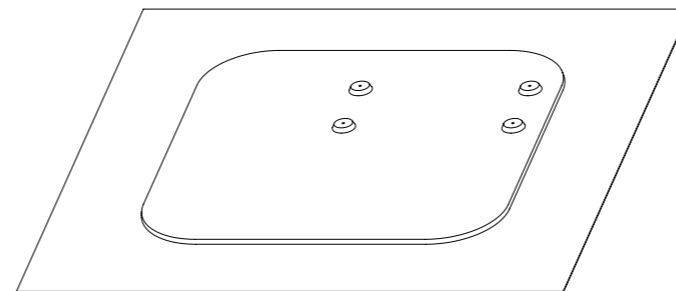

- 3** Use the rest of the washers and screws to secure the base to the top, the washer needs to be placed between the screw and the mounting plate. Do not tighten the screws fully. Make sure the side of the base and the side of the top are flush. Once they are flush, tighten the screw fully.

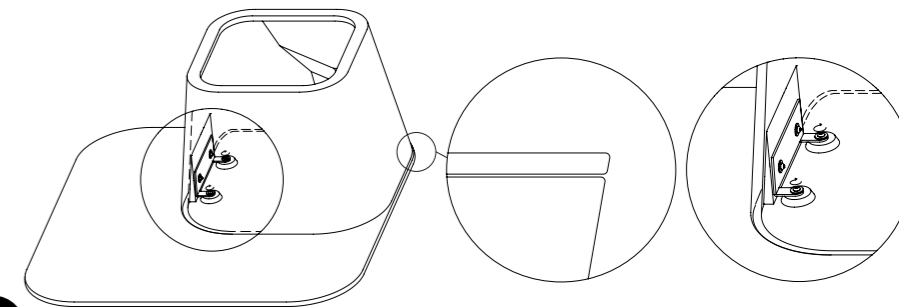

- 4** Stick the gliders to the bottom of the base in the designated location.

